



# SECUREDGE 2-PIECE COUNTERFLASHING

## SURFACE MOUNTED

### NOTES

- Pre-Notched Lap Joints
- No Fasteners Provided

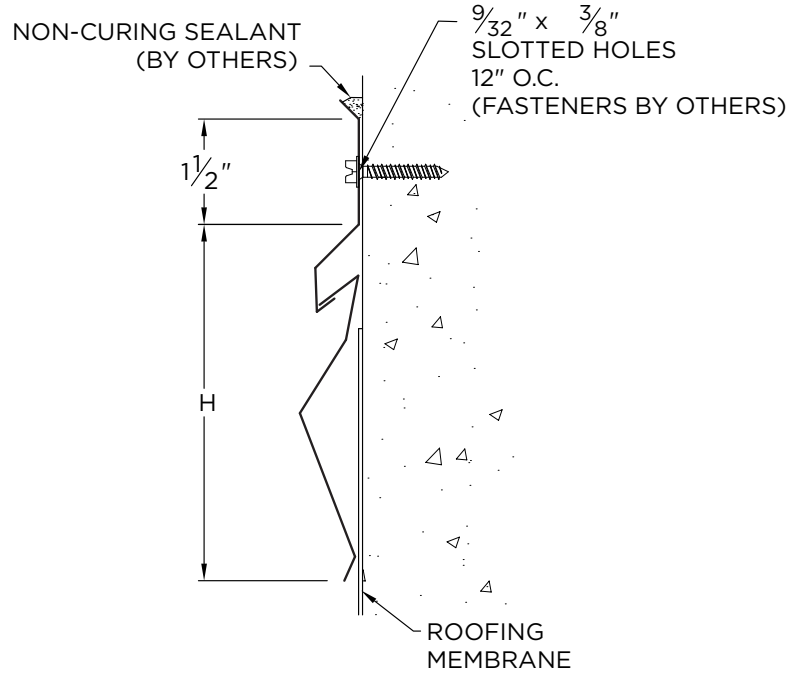

### PROJECT INFO

Project Name: \_\_\_\_\_

Architect: \_\_\_\_\_

Roofing Contractor: \_\_\_\_\_

#### Project Type:

By selecting this box you have verified and confirmed that dimensions, sizes, and quantities are correct. All products will be installed in strict accordance with printed instructions.

Date: \_\_\_\_\_

Customer Service  
866-458-3537  
(Metal-Era)

SHT #: \_\_\_\_\_ of \_\_\_\_\_

DATE: **09/24/24**

DRN BY: **JJC**

CKD BY: **MM**

DWG #: 15015-24439

REV: **C**

### DIMENSIONS

#### Surface Mounted (H DIM)

3.5" (CFW2-350R)

4" (CFW2-400R)

5" 5" (CFW2-500R)

### MATERIAL

24 Ga. Galv. Steel

22 Ga. Galv. Steel

.040" Aluminum

.050" Aluminum

OTHER: \_\_\_\_\_

Color: \_\_\_\_\_

Finish: \_\_\_\_\_

### QUANTITIES

\_\_\_\_\_ Lineal Feet (12'-0" Lengths)